

**⊗ ELECTRICAL KEYED NOTES**

- ELECTRIC UNIT HEATER: 3 KW, 208 VOLT, SINGLE PHASE, 300 CFM, TOTALLY ENCLOSED FACTORY-LUBRICATED MOTOR, STAINLESS STEEL TUBULAR HEATING ELEMENT, STAINLESS STEEL TUBULAR HEATING ELEMENT, BUILT-IN THERMOSTAT, 50-110°F, MOUNTING BRACKETS FOR CEILING OR WALL INSTALLATION INCLUDED. MOUNTING BRACKETS ALLOW 30° ROTATION OF THE UNIT. EPOXY/POLYESTER POWDER PAINT FINISH, 20 GAUGE STEEL CONSTRUCTION. ADJUSTABLE COVERS TO CONTROL WARM AIR FLOW. HIGH LIMIT TEMPERATURE CONTROL, WITH AUTOMATIC RESET. REZOR EGV OR EQUAL.
- PROVIDE A NEMA 5-20 DUPLEX, WEATHER RESISTANT, TAMPER RESISTANT GFCI, WHITE RECEPTACLE, HUBBELL, OF TROW OR EQUAL. INSTALL RECEPTACLE IN NEMA 3R, WEATHERPROOF, IN USE STYLE, EXTRA-DUTY, LOW PROFILE, UL-LISTED METALLIC BOX WITH LOCK HASP, TAYMAC MK42805 OR EQUAL. WHERE NOT MOUNTED ON A WALL, MOUNT THE RECEPTACLE TO A 6" LONG PIECE OF HOT-DIPPED GALVANIZED P1000 UNISTRUT INSTALLED WITH 3" BELOW GRADE.
- SHED LIGHT FIXTURE: LED STRIP LIGHT, NOMINAL 46.5" LONG, LIGHTWEIGHT COMPACT-DESIGNED CHANNEL, AND COVER ARE FORMED FROM COIL-ROLLED STEEL AND PAINTED AFTER FABRICATION, HIGH-GLOSS, BAKED WHITE ENAMEL. FINISH LEADS PROVIDE 88 COLOR RENDERING INDEX (CRI) AT 4000 KELVIN WITH LUMEN OUTPUT OF 2,100 LUMENS. DIFFUSE ACRYLIC LENS PROVIDING A SINGLE SMOOTH LINE OF LIGHT SHAPED TO RESEMBLE A FLUORESCENT TUBE. FIXTURE ACHIEVES 90% LUMEN MAINTENANCE AT 60,000 HOURS, PREDICTED LIFE OF MORE THAN 50,000 HOURS. FIXTURE ACCEPTS 120-277 VOLT INPUT. POWER RATING IS 24 WATTS. LITHONIA CONTRACTOR SELECT CATALOG NUMBER MNSL MVM OR EQUAL. SURFACE MOUNT FIXTURE TO CEILING.
- RE-WIRE EXISTING CHICKEN COOP LIGHTING AND EXTERIOR GFCI RECEPTACLE TO NEW CIRCUIT AS SHOWN.
- WITHIN THIS AREA, REMOVE AND DISPOSE OF ALL UNDERGROUND CONDUIT AND WIRING.

**ELECTRICAL SPECIFICATIONS**

- ALL ELECTRICAL WORK SHALL MEET THE REQUIREMENTS OF THE 2017 OHIO BUILDING CODE AND THE 2017 NATIONAL ELECTRICAL CODE. ALL EQUIPMENT SHALL BE NEW AND UL-LISTED.
- WIRING DEVICES SHALL MEET THE REQUIREMENTS OF NEMA WD-1. TOGGLE SWITCHES SHALL BE CONSTRUCTION SERIES HEAVY DUTY SPECIFICATION GRADE, AC TOGGLE SWITCHES, BACK AND SIDE WIRED, 20A, 125-277V AC, GREY COLOR, HUBBELL CS121GY OR EQUAL.
- WIRING METHOD SHALL BE #12 COPPER THIN IN 1/2" RACEWAY MINIMUM. METAL CLADE CABLE MAY BE USED AT INTERIOR LOCATION WITHIN THE NEW SHED. USE SCHEDULE 40 PVC FOR UNDERGROUND CIRCUITS. USE RIGID GALVANIZED STEEL CONDUIT FOR EXPOSED EXTERIOR LOCATIONS AND FOR PUSHING CONDUIT UNDER THE SIDEWALK. USE METAL BOXES AT INTERIOR LOCATIONS. USE CAST FERRALLOY BOXES AT EXTERIOR LOCATIONS. PROVIDE A #12 COPPER EQUIPMENT GROUND WIRE IN ALL RACEWAY RUNS AND TO ALL NEW EQUIPMENT. INTENDED CONDUIT RUNS BY THE CONTRACTOR SHALL FIRST BE REVIEWED AND APPROVED BY THE OWNER BEFORE INSTALLATION CAN COMMENCE.
- THE ELECTRICAL CONTRACTOR SHALL MAKE A FIELD SURVEY TO VERIFY THE EXISTING CONDITIONS AND DETERMINE THE EXTENT OF WORK INVOLVED PRIOR TO SUBMITTING A BID.
- EXISTING FIXTURES AND DEVICES THAT ARE TO REMAIN ARE TO BE PROTECTED FROM DAMAGE AND THEIR CIRCUITING TO BE MAINTAINED.
- ANY EXISTING CIRCUITS OR EQUIPMENT NOT SHOWN ON THE DRAWINGS AND WHICH ARE LOGICALLY EXPECTED TO BE CONTINUED IN SERVICE AND WHICH MAY BE INTERRUPTED OR DISTURBED DURING CONSTRUCTION SHALL BE RECONNECTED IN AN APPROVED MANNER. IN ADDITION, ANY EXISTING CIRCUIT OR EQUIPMENT WHICH MAY REQUIRE RELOCATION OR REWIRING AS A RESULT OF CONSTRUCTION SHALL BE CONSIDERED A PART OF THE WORK OF THIS BRANCH AND SHALL BE DONE BY THIS CONTRACTOR WITH NO ADDITIONAL COMPENSATION.
- THIS CONTRACTOR TO SECURE AND PAY FOR PERMITS AND INSPECTIONS REQUIRED FOR ELECTRICAL WORK.
- TEST FOR GROUNDS AND SHORTS AND CORRECT ALL DEFICIENCIES.

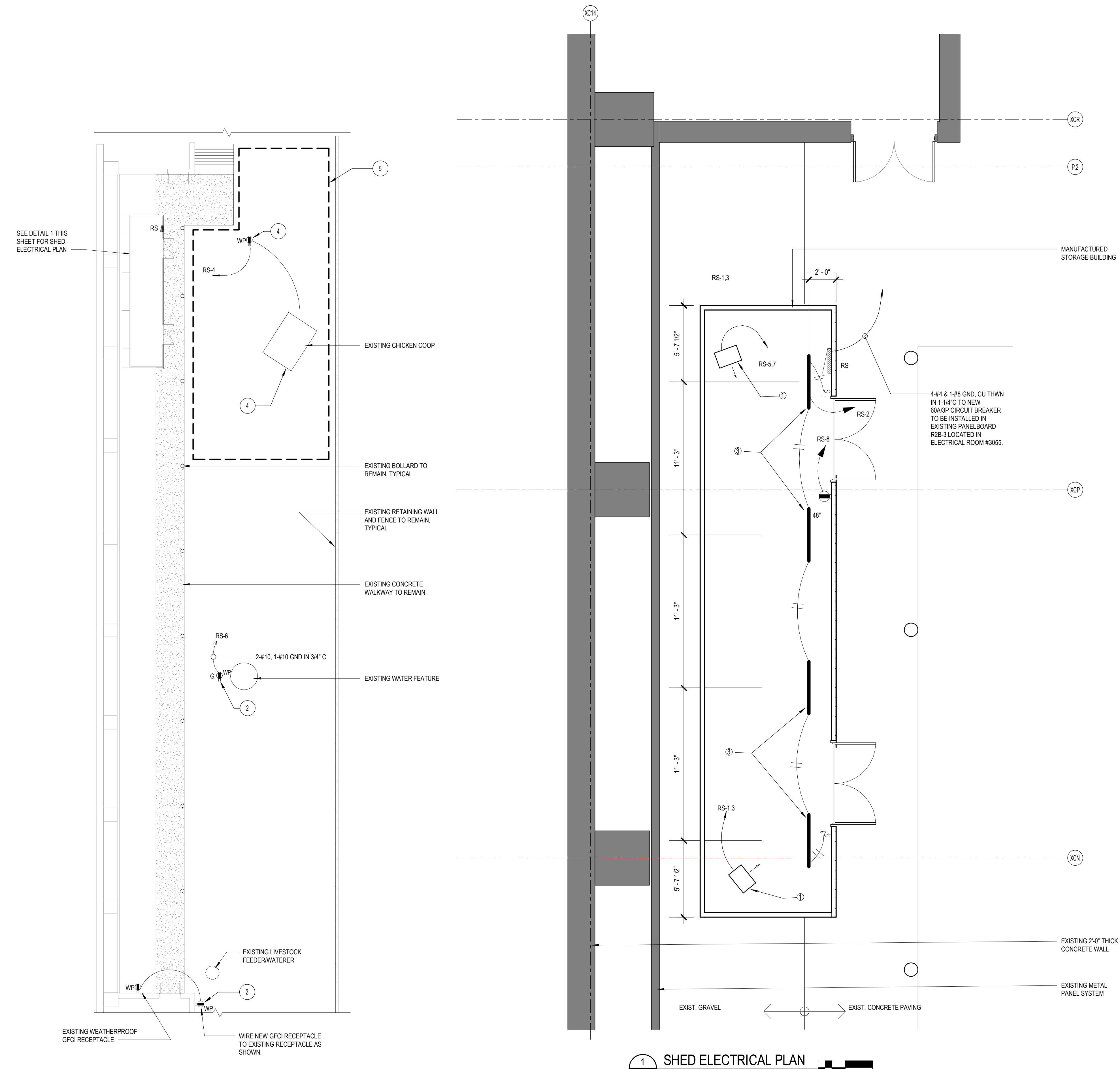

**2 ELECTRICAL SITE PLAN**  
SCALE: 1/16" = 1'-0"  
0' 2' 4' 8' 16'

**1 SHED ELECTRICAL PLAN**  
SCALE: 1/4" = 1'-0"  
0' 6" 1' 2' 4'

LOAD CENTER SCHEDULE		VOLTS 208Y/120V			PANEL NAME: RS			NEMA ENCLOSURE: 1					
SURFACE MOUNTED		PHASE 3			TYPE: SIEMENS PL			FACTORY GROUND BARS					
100A COPPER BUS		WIRE 4			MAINS: 60A MCB			AIC RATING: 10,000					
CKT	LOAD	VA	AMPS	POLE	A	B	C	AMPS	POLE	VA	NOTE	DESCRIPTION	CKT
1	ELECTRIC UNIT HEATER	1500	20	2	1596			20	1	96		LIGHTS IN SHED	2
3		1500				2000			1	500		CHICKEN COOP AND EXT REC	4
5	ELECTRIC UNIT HEATER	1500	20	2			2364	20	1	864		CIRC. PUMP @ POOL, 1/3 HP	6
7		1500			1680			20	1	180		GFCI REC IN SHED	8
9	SPARE		20	1		0		20	1			SPARE	10
11	SPARE		20	1			0	20	1			SPARE	12
13	SPACE		20	1	0			20	1			SPACE	14
15	SPACE		20	1		0		20	1			SPACE	16
17	SPACE		20	1			0	20	1			SPACE	18
19	SPACE		20	1	0			20	1			SPACE	20
21	SPACE		20	1		0		20	1			SPACE	22
23	SPACE		15	1			0	20	1			SPACE	24
25	SPACE		20	1	0			20	1			SPACE	26
27	SPACE		20	1		0		20	1			SPACE	28
29	SPACE		20	1			0	20	1			SPACE	30

VA	3276	2000	2364
AMPS	27.3	16.7	19.7

7640	TOTAL CONNECTED LOAD (VA)
21.2	TOTAL CONNECTED AMPS
7664	TOTAL DEMAND LOAD (VA)
21.3	TOTAL DEMAND AMPS

PANEL SHALL MEET THE REQUIREMENTS OF NEMA PB-1