



Hilton

CLEVELAND DOWNTOWN

FLOOR 3 CENTER STREET MEETING ROOMS

CLEVELAND NOW BOARDROOM
29' x 20' x 9'

Hope Ballroom A-B
65' x 49' x 18'

Hope Ballroom A-C
104' x 49' x 18'

Hope Ballroom A-D
104' x 110' x 18'

Hope Ballroom B-C
71' x 49' x 18'

Hope Ballroom D-E
104' x 115' x 18'



FLOOR 5 VETERANS MEETING ROOMS

Superior Ballroom A-B
127' x 56' x 22'

Superior Ballroom A-C
127' x 116' x 22'

Superior Ballroom C-D
127' x 119' x 22'

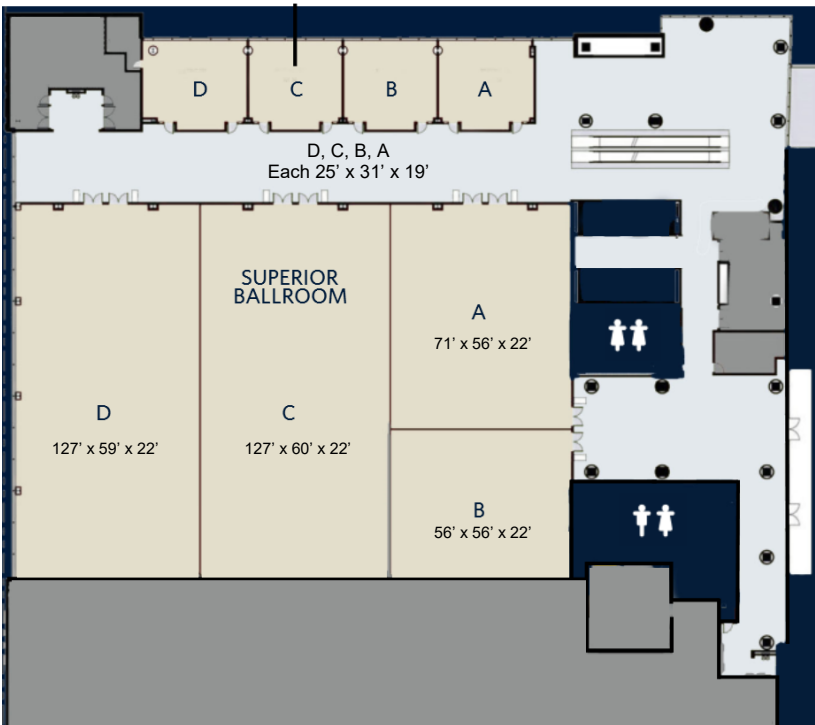

	SQUARE FOOTAGE	L X W X H	MAX CEILING HEIGHT	THEATRE	CLASSROOM	U-SHAPE	BANQUET	CONFERENCE	HOLLOW SQUARE	RECEPTION
Level 3										
3rd Floor Lakeside Foyer	3,603 ft ²	91' x 61' x 11'	29'	—	—	—	—	—	—	200
Center Street Meeting Room A	1,469 ft ²	52' x 28' x 12'	14'	140	64	36	100	34	42	140
Center Street Meeting Room B-C	2,970 ft ²	52' x 59' x 12'	14.1'	220	104	—	160	—	—	280
Center Street Meeting Room B	1,485 ft ²	52' x 30' x 12'	14.1'	140	64	36	100	34	42	142
Center Street Meeting Room C	1,493 ft ²	52' x 30' x 12'	14.1'	140	64	36	100	34	42	144
Center Street Meeting Room D	1,512 ft ²	52' x 31' x 12'	14'	140	64	36	100	34	42	145
Cleveland Now Boardroom	537 ft ²	29' x 20' x 9'	17.6'	—	—	—	—	12	—	—
Hope Ballroom	15,861 ft ²	97' x 164' x 18'	18.3'	1,510	680	—	1,120	—	—	1,560
Hope Ballroom A	1,592 ft ²	33' x 49' x 18'	18.3'	150	68	42	120	40	48	150
Hope Ballroom A-B	3,121 ft ²	65' x 49' x 18'	18.3'	302	128	62	200	52	72	300
Hope Ballroom A-C	4,749 ft ²	104' x 49' x 18'	18.3'	460	196	—	320	—	—	460
Hope Ballroom A-D	10,666 ft ²	104' x 110' x 18'	18.3'	1,020	440	—	720	—	—	1,040
Hope Ballroom B	1,529 ft ²	32' x 49' x 18'	18.3'	144	68	42	120	40	48	148
Hope Ballroom B-C	3,157 ft ²	71' x 49' x 18'	18.3'	306	130	62	200	52	72	304
Hope Ballroom C	1,628 ft ²	39' x 49' x 18'	18.3'	154	70	42	120	40	48	155
Hope Ballroom D	5,917 ft ²	104' x 61' x 18'	18.3'	540	244	—	400	—	—	580
Hope Ballroom D-E	11,112 ft ²	104' x 115' x 18'	18.3'	1,050	448	—	800	—	—	1,080
Hope Ballroom E	5,194 ft ²	104' x 54' x 18'	18.3'	490	220	—	360	—	—	500
Level 5										
5th Level Lakeside Foyer	2,605 ft ²	80' x 62' x 19'	10.5'	—	—	—	—	—	—	200
Superior Ballroom	20,959 ft ²	119' x 175' x 22'	22.3'	2,016	900	—	1,520	—	—	2,080
Superior Ballroom A	3,969 ft ²	71' x 56' x 22'	22.3'	380	168	62	250	52	72	380
Superior Ballroom A-B	6,719 ft ²	127' x 56' x 22'	22.3'	640	272	—	480	—	—	640
Superior Ballroom A-C	13,960 ft ²	127' x 116' x 22'	22.3'	1,310	572	—	1,000	—	—	1,380
Superior Ballroom B	2,750 ft ²	56' x 56' x 22'	22.3'	260	112	52	180	42	62	255
Superior Ballroom C	7,240 ft ²	127' x 60' x 22'	22.3'	690	310	—	500	—	—	700
Superior Ballroom C-D	14,240 ft ²	127' x 119' x 22'	22.3'	1,340	600	—	1,000	—	—	1,400
Superior Ballroom D	7,000 ft ²	127' x 59' x 22'	22.3'	670	300	—	500	—	—	680
Veterans	2,983 ft ²	25' x 123' x 19'	10.5'	—	—	—	160	—	—	275
Veterans Meeting Room A	752 ft ²	25' x 31' x 19'	10.5'	68	32	22	40	22	30	70
Veterans Meeting Room A-B	1,482 ft ²	25' x 62' x 19'	10.5'	124	60	42	80	40	46	140
Veterans Meeting Room A-C	2,218 ft ²	25' x 92' x 19'	10.5'	—	—	—	120	—	—	200
Veterans Meeting Room B	738 ft ²	25' x 31' x 19'	10.5'	68	32	22	40	22	30	70
Veterans Meeting Room B-C	1,483 ft ²	25' x 62' x 19'	10.5'	124	60	42	80	40	46	140
Veterans Meeting Room B-D	2,238 ft ²	25' x 92' x 19'	10.5'	—	—	—	120	—	—	200
Veterans Meeting Room C	739 ft ²	25' x 31' x 19'	10.5'	68	32	22	40	22	30	70
Veterans Meeting Room C-D	1,508 ft ²	25' x 62' x 19'	10.5'	124	60	42	80	40	46	140
Veterans Meeting Room D	765 ft ²	25' x 31' x 19'	10.5'	68	32	22	40	22	30	70